



**Northfields, Lode CB25 9EU**

**Guide Price £295,000**

**MA**

Morris Armitage

01638 742461

[www.morrisarmitage.co.uk](http://www.morrisarmitage.co.uk)

## Northfields, Lode CB25 9EU

A well located semi detached bungalow positioned on a generous plot in the popular village of Lode available with NO UPWARD CHAIN.

The accommodation comprises of a living room, kitchen/diner, two bedrooms and a bathroom.

Externally, there is a generous front, rear and side garden which offers the opportunity to extend and still retain a large garden. The property is in need of some general modernisation and must be seen to be fully appreciated.

Lode is a small, picturesque village located about 6 miles northeast of Cambridge, known for its tranquil surroundings and rural charm. For more extensive shopping and amenities, residents typically travel to nearby Cambridge, which offers a wide array of shops, restaurants, and cultural attractions, including the historic university and museums. The village is well-connected by road and public transport, making it convenient to access Cambridge and surrounding areas, such as Newmarket (approximately 15 miles away) and Ely (around 11 miles away). With scenic walks and a friendly community atmosphere, Lode is an appealing choice for those seeking a quieter lifestyle close to the vibrant city of Cambridge.

### Entrance Hall

With doors to all rooms.

### Kitchen/Diner

Fitted with range of matching eye and base level cupboards with worktop over. Stainless steel sink and drainer with mixer tap over. Space and connection for electric cooker with extractor above. Space and plumbing for washing machine. Space for fridge/freezer. Tiled splashbacks. Wood effect flooring. Radiator. Window to rear aspect. Glazed door to rear lobby. Door to entrance hall.

### Living Room 11'11" x 10'7" (3.64m x 3.25m)

Generous living room with dual windows to front aspect. Radiator. Door to entrance hall.

### Bedroom 1 11'4" x 10'9" (3.46m x 3.29)

Spacious double bedroom with window to front aspect. Radiator. Door to entrance hall.

### Bedroom 2 8'6" x 7'8" (2.60m x 2.36m)

Double bedroom with window to rear

aspect. Radiator. Door to entrance hall.

### Bathroom 7'8" x 6'8" (2.36m x 2.05m)

White suit comprising, low level, concealed cistern, W.C., wall mounted hand basin with built-in cabinet under and panelled bath. Tiled throughout. Obscured window. Door to entrance hall.

### Rear Lobby

With doors leading to front and rear and kitchen/diner.

### Outside - Front

Driveway providing off road parking, leading to garage with up and over door. Pathway leading to front porch and rear garden. Planted borders.

### Outside - Rear

Well maintained garden with large lawned area with pathway leading to front and rear. Patio area. Planted borders.

### PROPERTY INFORMATION

EPC - C

Tenure - Freehold

Council Tax Band - C (East Cambs)  
Property Type - Semi-Detached Bungalow

Property Construction – Standard  
Number & Types of Room – Please refer to the floorplan

Square Meters - 56 SQM

Parking – Driveway & Garage

Electric Supply - Mains

Water Supply – Mains

Sewerage - Mains

Heating sources - Gas

Broadband Connected - tbc

Broadband Type – Superfast available, 1000Mbps download, 1000Mbps upload

Mobile Signal/Coverage – Ofcom advise likely on all networks

Rights of Way, Easements, Covenants – None that the vendor is aware of



**GROUND FLOOR**  
599 sq.ft. (55.6 sq.m.) approx.

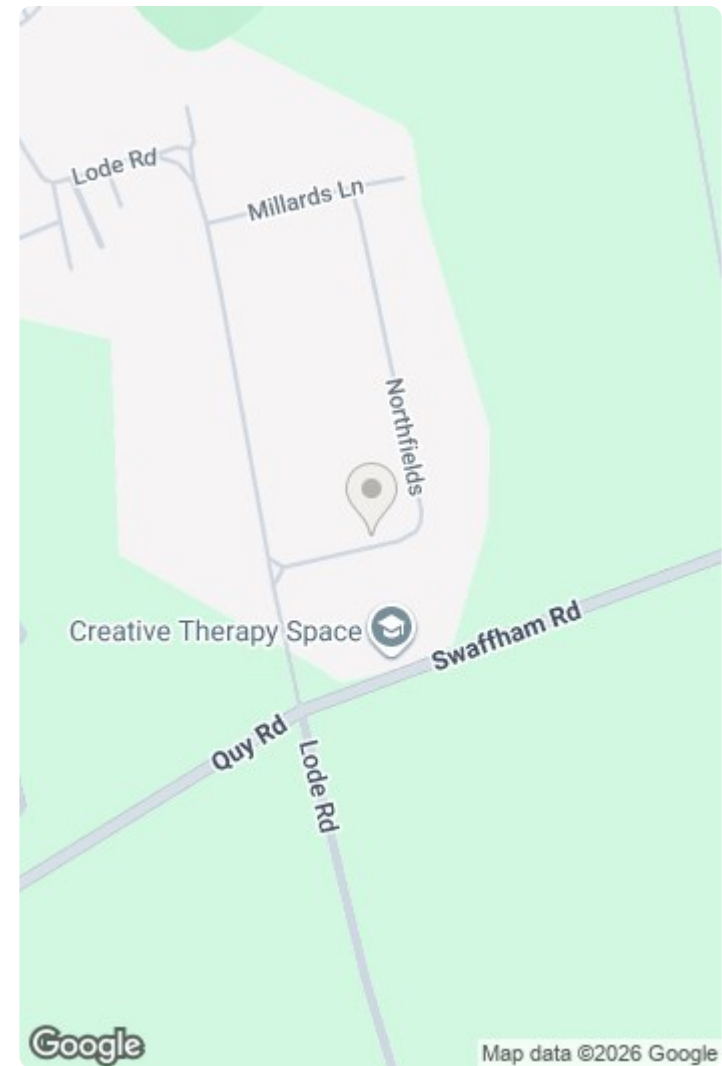
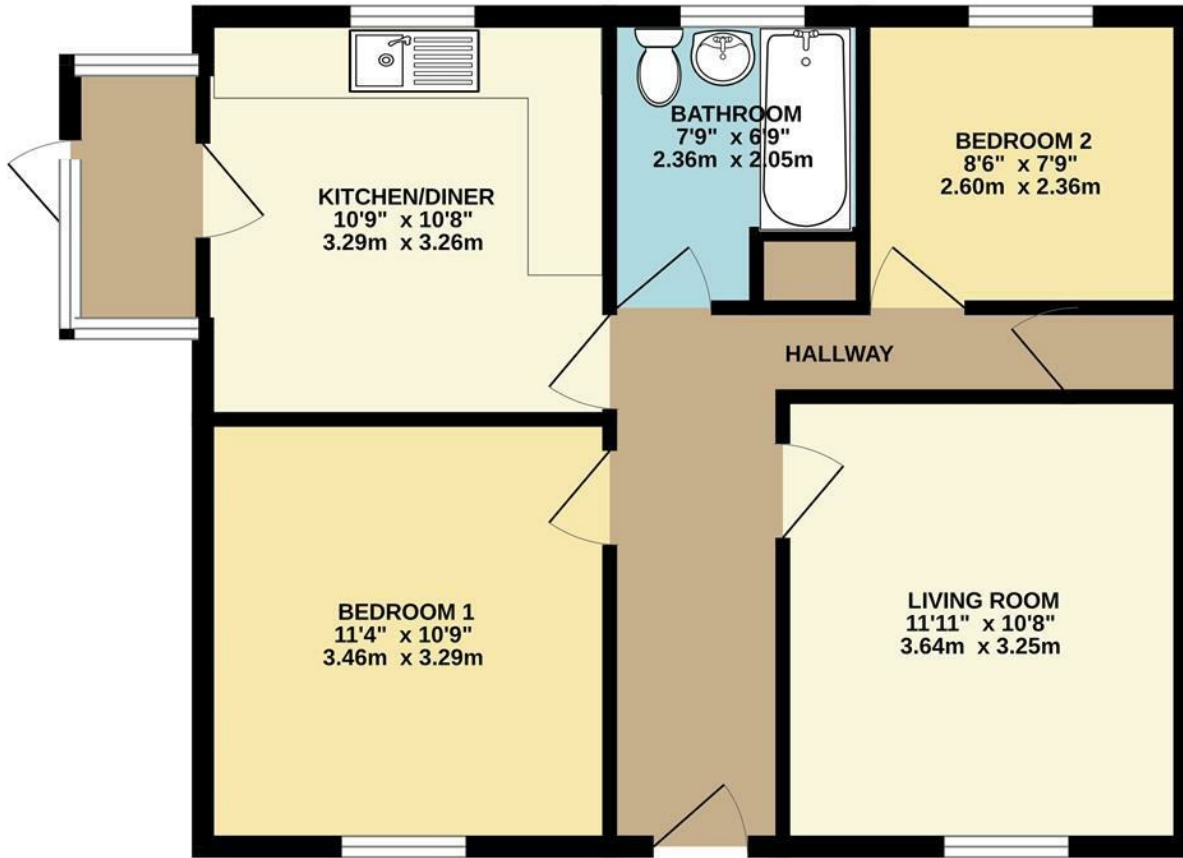

TOTAL FLOOR AREA : 599 sq.ft. (55.6 sq.m.) approx.

Whilst every attempt has been made to ensure the accuracy of the floorplan contained here, measurements of doors, windows, rooms and any other items are approximate and no responsibility is taken for any error, omission or mis-statement. This plan is for illustrative purposes only and should be used as such by any prospective purchaser. The services, systems and appliances shown have not been tested and no guarantee as to their operability or efficiency can be given.  
Made with Metropix ©2025

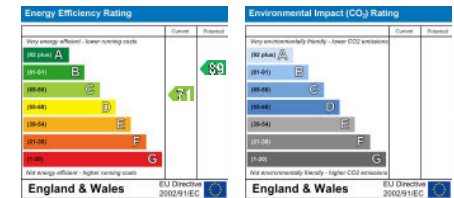

This document and any marketing relating to the property has been prepared in good faith to give a fair overall view of the property and must not be relied upon as statements or representations of fact. It is suggested that undertake enquiries by inspections, survey or other investigation to ascertain the viability of any purchase. Any areas, measurements or distances referred to are given as a guide only and are not precise and no liability can be accepted for errors arising them therefrom. Photographs are not necessarily comprehensive nor current; no assumption should be made that any contents shown are included in the sale. Morris Armitage have not tested any services or equipment and nothing in these particulars should be deemed to be a statement that they are in good working order nor that the property is in good structural condition.

